

# Sailing catamaran

## Leopard 48

BASIC INFORMATION	LAYOUT
<ul style="list-style-type: none"> <li>▪ Year: 2016, 2017</li> <li>▪ Length: 14.75 m</li> <li>▪ Beam: 7.64 m</li> <li>▪ Draft: 1.31 m</li> <li>▪ Displacement: 17,000 kg</li> <li>▪ Engines: 2 x 54 HP</li> <li>▪ Fuel tank: 700 L</li> <li>▪ Water tank: 1000 L</li> <li>▪ Double cabins: 4</li> <li>▪ Single cabins: 2</li> <li>▪ Bed in saloon: convertible table</li> <li>▪ Persons [recomm./licensed]: 8 / 10</li> <li>▪ Showers [cabins + forepeak + deck]: 4 + 1 + 1</li> <li>▪ Heads [cabins + forepeak]: 4 + 1</li> </ul>	 <p>The diagram shows the deck layout of the Leopard 48 catamaran. It features two main cabin areas, each with a 'single cabin deck and cabin access' point. There is also a 'single cabin deck access, WC and shower' located at the stern of the vessel.</p>
HIGHLIGHTS	HIGHLIGHTS - continued
<ul style="list-style-type: none"> <li>▪ <b>Air-conditioning System - Cruisair</b> (in saloon and cabins)</li> <li>▪ <b>Genset – for Leopard 48 (2016) Fisher Panda 8 kW, for Leopard 48 (2017) Norther Lights 9kW</b></li> <li>▪ <b>Inverter/Battery Charger: 12V - 220V 2.7kW</b></li> <li>▪ <b>Watermaker (12V), 60L/h with controller</b></li> <li>▪ <b>220V Shore Power Pack</b></li> <li>▪ <b>Custom stainless steel davit system with tackle c/w electric winch</b></li> <li>▪ <b>Electric Sheet winch - Lewmar 55EST</b></li> <li>▪ <b>Fusion 700i Series Marine Stereo in saloon with docking station</b></li> <li>▪ <b>External speakers in forward cockpit: 2 x speakers with wired remote and amplifier</b></li> </ul>	<ul style="list-style-type: none"> <li>▪ <b>2x Solar panels 70W each fitted to hard top</b></li> <li>▪ <b>Leopard 48 2016 - Electric flushing toilets: 2 Jabsco quiet flush (seawater option; aft cabins) &amp; 2 standard manual toilets (fwd cabins)</b></li> <li>▪ <b>Leopard 48 2017 - Electric flushing toilets: 4 Jabsco quiet flush (seawater option)</b></li> <li>▪ <b>Combination mixer shower faucet in galley</b></li> <li>▪ <b>Cockpit 12V Refrigerator</b></li> <li>▪ <b>Teak deck</b></li> <li>▪ <b>Stern shower: hot/cold water</b></li> <li>▪ <b>Dinghy with outboard engine 9,9 HP</b></li> <li>▪ <b>Ventilation fans in cabins and saloon</b></li> <li>▪ <b>Double USB socket in cabins (x4)</b></li> </ul>
SALOON	HEADS COMPARTMENTS x 4 (4 CABIN VERSION)
<ul style="list-style-type: none"> <li>▪ <b>Saloon table convertible to a coffee table or to standard double bed, c/w mattress</b></li> <li>▪ <b>2x Ventilation fans in saloon</b></li> <li>▪ <b>Air-conditioning System - Cruisair</b> (in saloon and cabins)</li> <li>▪ <b>Provision for TV/DVD in saloon</b> - swing bracket and AC outlet</li> <li>▪ Laminate finishes with solid wood trims</li> <li>▪ Settee - U-shape</li> <li>▪ Wear resistant simulated wood flooring</li> <li>▪ LED overhead lighting</li> <li>▪ Ample ventilation through fwd facing portlights</li> <li>▪ Stowage space under settee cushions</li> <li>▪ 2 x Escape hatches under stairways to hulls</li> <li>▪ Front doorway access to forward cockpit</li> </ul>	<ul style="list-style-type: none"> <li>▪ <b>Leopard 48 2016 - Electric flushing toilets: 2 Jabsco quiet flush (seawater option; aft cabins) &amp; 2 standard manual toilets (fwd cabins)</b></li> <li>▪ <b>Leopard 48 2017 - Electric flushing toilets: 4 Jabsco quiet flush (seawater option)</b></li> <li>▪ Washbasins with basin mixer and Corian top</li> <li>▪ Vanity locker with mirror</li> <li>▪ Towel hook, rail and ring</li> <li>▪ Separate shower compartment with acrylic door c/w lever mixer and adjustable shower rose</li> <li>▪ Shower sump with push-button drainage</li> <li>▪ LED Overhead lighting</li> <li>▪ Overhead roller blinds for privacy</li> <li>▪ Large bowl toilet</li> </ul>
GALLEY	ENGINE & CONTROLS
<ul style="list-style-type: none"> <li>▪ <b>Combination mixer shower faucet in galley</b></li> <li>▪ <b>Galley full equipped</b> - plates, cups, saucers, glasses, flatware for twelve; pots, pans, miscellaneous food prep; cooking &amp; serving utensils; kettle, microwave, blender, coffee maker, ice maker, citrus press</li> <li>▪ Corian galley worktop surfaces</li> <li>▪ Single lever mixer faucet</li> <li>▪ Double s/s sink</li> <li>▪ Dish and cutlery drying recess with drainage</li> <li>▪ Vitrifrigo 2-drawer front-opening fridge/freezer 56USgal / 212Ltr 12v refrigeration</li> </ul>	<ul style="list-style-type: none"> <li>▪ <b>2 x Yanmar 4JH5CE 54 HP engines with sail drives</b></li> <li>▪ Double lever throttle / gearshift control</li> <li>▪ Sound deadening panels in engine room</li> <li>▪ 2 x Engine room ventilation fans and ducting</li> <li>▪ 2 x Propellers - 3-blade fixed</li> <li>▪ 2 x Fuel deck fillers</li> <li>▪ 2 x Fuel filter / water separators</li> <li>▪ 2 x Fuel tanks aluminum 185USgal / 700Ltr total capacity</li> <li>▪ 2 x Exhaust skin fittings (s/s)</li> <li>▪ 2 x Exhaust water locks</li> <li>▪ 2 x Cooling water inlet strainers</li> </ul>

# Sailing catamaran

## Leopard 48

<ul style="list-style-type: none"> <li>▪ ENO gas 3-burner hob</li> <li>▪ Gas solenoid shut-off valve with control at switch panel &amp; warning light at cooker</li> <li>▪ Gas cylinder regulator in dedicated cockpit LPG locker</li> <li>▪ Separate garbage bin locker with side &amp; top access</li> <li>▪ Stowage space in shelf lockers</li> <li>▪ Corian galley shelf with spice rack</li> <li>▪ 4 x Galley drawers</li> <li>▪ 1 x Pot storage drawer below oven</li> <li>▪ 1 x Large overhead storage drawer</li> </ul>	<ul style="list-style-type: none"> <li>▪ 2 x Exhaust cooling water temperature sensors with audible alarms at helm</li> </ul>
<b>NAVIGATION CONSOLE</b>	<b>NAVIGATION EQUIPMENT</b>
<ul style="list-style-type: none"> <li>▪ Chart table surface with overhead LED light</li> <li>▪ Instrument and switch panel</li> <li>▪ Chart table bench seat c/w stowage under cushion</li> </ul>	<ul style="list-style-type: none"> <li>▪ <b>Raymarine Base Pack: includes Ray55 VHF at navstation (EUROPE - Rest of the World), p70 color autopilot display, log &amp; depth instrument with retract, depth &amp; speed transducers</b></li> <li>▪ <b>Raymarine Color Upgrade: 2x i70 color instrument displays</b> (instead of i60 wind instrument and i50 Tridata)</li> <li>▪ <b>Raymic 2nd station VHF at helm for Ray55</b></li> <li>▪ <b>e95 Hybridtouch multifunction display with WiFi at helmstation</b></li> <li>▪ <b>HD Colour Radar includes 4 kW 18" 48nm Radome scanner</b></li> <li>▪ <b>Raymarine Automatic identification System AIS 650 Transceiver</b></li> <li>▪ <b>AIS, autopilot, EPIRB, GPS, Radar, speed log, VHF, wind instruments</b></li> <li>▪ Compass at helm position</li> </ul>
<b>CABINS x 4 (4 CABIN VERSION)</b>	<b>RUDDER &amp; STEERING SYSTEM</b>
<ul style="list-style-type: none"> <li>▪ <b>4x Full length mirrors behind cabin doors</b></li> <li>▪ <b>4x Ventilation fans in cabins</b></li> <li>▪ <b>Double USB socket in cabins (x4)</b></li> <li>▪ <b>Air-conditioning System - Cruisair</b> (in saloon and cabins)</li> <li>▪ Laminate finishes with solid wood trims</li> <li>▪ <b>Double berths:</b> <ul style="list-style-type: none"> <li>- <b>Fwd Bunks (56in / 1.42m x 80in / 2.05m)</b></li> <li>- <b>Aft Bunks (59in / 1.50m x 80in / 2.05m)</b></li> </ul> </li> <li>▪ 2 x Engine room ventilation fans and ducting</li> <li>▪ Hanging locker with lower shelf</li> <li>▪ Bedside cave locker/table</li> <li>▪ LED lighting - overhead reading lamps</li> <li>▪ Overhead roller blinds for privacy</li> <li>▪ Large open shelves</li> <li>▪ Stowage drawers under bunk</li> <li>▪ Large hull window incorporating portlight and pleated blind</li> </ul>	<ul style="list-style-type: none"> <li>▪ <b>Leather covered steering wheel</b></li> <li>▪ Balanced spade rudders</li> <li>▪ Rudder stock in F16ph stainless steel</li> <li>▪ JP3 Self aligning bearings</li> <li>▪ Chain and wire steering system c/w bulkhead steering unit and brake</li> <li>▪ Emergency tiller (s/s)</li> </ul>
<b>FOREPEAK – single cabins</b>	<b>ELECTRICAL INSTALLATION</b>
<ul style="list-style-type: none"> <li>▪ <b>Forepeak berth and heads starboard including light, fan, PAR Brydon large bowl manual toilet, hand basin complete with combination faucet/shower mixer; right peak access from deck only</b></li> <li>▪ <b>Forepeak berth port including light and fan with access from the deck and forward cabin</b></li> </ul>	<ul style="list-style-type: none"> <li>▪ <b>Fusion 700i Series Marine Stereo in saloon with docking station.</b> Includes Bluetooth, USB &amp; AUX connectivity. Fusion Marine speakers in saloon (2) &amp; aft cockpit (2). Wired remote control at helm station (1). - Note: Raymarine MDFs &amp; personal wireless devices (only if connected wirelessly to Raymarine MDF via the Raymarine APP) can control system</li> <li>▪ <b>External speakers in forward cockpit: 2 x speakers with wired remote and amplifier</b></li> <li>▪ <b>220V Shore Power Pack:</b> includes 2x heavy duty 50 ft 30 amp shore powerlines, AC switch panel, HWC 220V conversion, AC outlets in cabins, galley, at freezer and switch panel</li> </ul>

# Sailing catamaran

## Leopard 48

	<ul style="list-style-type: none"> <li>▪ <b>Inverter/Battery Charger:</b> 12V - 220V 2.7kW inverter with 125A charge rate, including remote operation panel with battery monitor</li> <li>▪ <b>Upgrade standard Lead Acid house and engine batteries to AGM batteries</b></li> <li>▪ <b>Two additional AGM house batteries (210 Ah)</b></li> <li>▪ <b>Ventilation fans in saloon (x2) and cabins (x4)</b></li> <li>▪ <b>Double USB socket in cabins</b> - for 4 cabin layout</li> <li>▪ <b>Genset – for Leopard 48 (2016) Fisher Panda 8 kW, for Leopard 48 (2017) Norther Lights 9kW</b></li> <li>▪ <b>Air-conditioning System - Cruisair: 40,000 BTU Total</b> [(2) 12,000 BT and (1) 16,000 BTU] 220v [saloon and cabins]</li> <li>▪ <b>Electric Sheet winch - Lewmar 55EST</b> - 1 off</li> <li>▪ <b>Provision for TV/DVD in saloon</b> - swing bracket and AC outlet</li> <li>▪ <b>2x Solar panels 70W each fitted to hard top</b></li> <li>▪ <b>Watermaker (12V), 60L/h with controller</b></li> <li>▪ <b>Custom stainless steel davit system with tackle c/w electric winch</b></li> <li>▪ LED Courtesy lights at stairways</li> <li>▪ LED Bi-colour &amp; stern navlights</li> <li>▪ 12v DC switch panel</li> <li>▪ 2 x 12v outlet sockets at switch panel and at helm station</li> <li>▪ 2 x Fuel tank gauges at helm position</li> <li>▪ 2 x Ammeters at helm position</li> <li>▪ 2 x House batteries - 210Ah deep cycle lead acid type</li> <li>▪ 2 x Engine starter batteries - 100Ah lead acid type</li> <li>▪ 1 x House battery isolator switch</li> <li>▪ 2 x Engine starter battery isolator switches</li> <li>▪ 2 x Alternators, standard with engines</li> <li>▪ 1 x Electrical spares kit: fuses, relays, fuse holders</li> <li>▪ 1 x Electric fog horn with control at helm station</li> </ul>
<b>DECK FITTINGS</b>	<b>DECK FITTINGS - continued</b>
<ul style="list-style-type: none"> <li>▪ <b>2x Solar panels 70W each fitted to hard top</b></li> <li>▪ <b>Deck wash fitting - dual fresh/salt water system</b></li> <li>▪ <b>Stern shower: hot/cold water</b></li> <li>▪ <b>LPG gas outlet on stern rail for optional BBQ</b></li> <li>▪ <b>Cockpit 12V Refrigerator</b></li> <li>▪ <b>Removable helm seat spray dodger</b></li> <li>▪ <b>Aft cockpit side &amp; back shade curtains only</b></li> <li>▪ <b>Aft cockpit cushions</b></li> <li>▪ <b>Forward cockpit cushions</b></li> <li>▪ <b>Custom stainless steel davit system with tackle c/w electric winch</b></li> <li>▪ <b>Composite teak deck:</b> aft and toward cockpits, helm platform, transom steps</li> <li>▪ 1500w vertical windlass 10mm gypsy c/w hand-held remote</li> <li>▪ Anchor bow roller fitting</li> <li>▪ Anchor chain stopper</li> <li>▪ Liferaft locker with convertible fore/aft seat bolster</li> <li>▪ Sliding companionway door - 2 leaf</li> <li>▪ Hardtop over cockpit complete with LED lighting</li> <li>▪ Hardtop bimini over helm c/w s/s supports and LED light</li> <li>▪ Swimming ladder</li> <li>▪ Cockpit table</li> <li>▪ Furler jammer on deck</li> <li>▪ Bridle mainsheet system (3:1 purchase)</li> </ul>	<ul style="list-style-type: none"> <li>▪ Portlights: <ul style="list-style-type: none"> <li>- 2 x Size 5 in windscreen</li> <li>- 10 x Size 1 in hull side and transom</li> </ul> </li> <li>▪ Guardwires with stanchions, bases, port &amp; stb side gates</li> <li>▪ Guardwires across bow and stern</li> <li>▪ 1x Chain locker</li> <li>▪ 1x Anchor/windlass locker</li> <li>▪ 2 x Foredeck lockers</li> <li>▪ Forward lounging cockpit with hardtop c/w watertight saloon access door and sliding hatch for foredeck access</li> <li>▪ 1 x Forward cockpit locker</li> <li>▪ 2 x Seats c/w stowage locker under in fwd cockpit</li> <li>▪ 2 x Pulpits with seat</li> <li>▪ 2 x Pushpits</li> <li>▪ 2 x Coachroof s/s handrails</li> <li>▪ 7 x 330mm mooring cleats</li> <li>▪ 2 x Winch handles</li> <li>▪ <b>1 x Halyard / sheet electric winch</b></li> <li>▪ 1 x Halyard / sheet winch</li> <li>▪ 1 x Main sheet winch</li> <li>▪ 2 x Genoa cars with pin stop</li> <li>▪ 2 x Genoa tracks</li> <li>▪ 1 x Winch handle pocket at helm</li> <li>▪ 2 x Halyard clutch at helm (Main &amp; Gennaker)</li> </ul>

# Sailing catamaran

## Leopard 48

<ul style="list-style-type: none"> <li>▪ Trampoline</li> <li>▪ Helmseat</li> <li>▪ Lifering holder</li> <li>▪ Acrylic smoke grey tinted windows</li> <li>▪ Hardtop s/s supports</li> <li>▪ Side window brows</li> <li>▪ Hatches:               <ul style="list-style-type: none"> <li>- 4 x Size 10 Flush Hatch over heads</li> <li>- 4 x Size 44 Flush Hatch over cabins</li> <li>- 2 x Size 60 Flush Hatch on foredeck (vented)</li> <li>- 1 x Size 70 Flush Hatch over cockpit</li> </ul> </li> </ul>	<ul style="list-style-type: none"> <li>▪ 2 x Genoa clutch at helm</li> <li>▪ 2 x Mainsheet clutch at helm</li> <li>▪ 2 x Reef clutch at helm</li> <li>▪ 1 x Mainsail outhaul clutch at helm</li> <li>▪ 1 x Clutch and cleat on mast for genoa halyard</li> <li>▪ 4 x Padeyes to allow for gennaker tackle</li> <li>▪ Drinks holders:               <ul style="list-style-type: none"> <li>- 4 in forward cockpit</li> <li>- 2 at helmstation</li> <li>- 1 in cockpit</li> </ul> </li> </ul>
<b>PLUMBING INSTALLATION</b>	<b>MAST, RIGGING &amp; SAILS</b>
<ul style="list-style-type: none"> <li>▪ <b>Leopard 48 2016 - Electric flushing toilets: 2 Jabsco quiet flush (seawater option; aft cabins) &amp; 2 standard manual toilets (fwd cabins)</b></li> <li>▪ <b>Leopard 48 2017 - Electric flushing toilets: 4 Jabsco quiet flush (seawater option)</b></li> <li>▪ <b>Watermaker (12V), 60L/h with controller</b></li> <li>▪ <b>Deck wash fitting - dual fresh/salt water system</b></li> <li>▪ <b>Stern shower: hot/cold water</b></li> <li>▪ Hot and cold pressurized fresh water system consisting of:               <ul style="list-style-type: none"> <li>▪ 2 x Water tanks, 1000L total capacity</li> <li>▪ 1 x 3.5 GPM fresh water pressure pump with 1L accumulator tank</li> <li>▪ 2 x Hot water cylinders 12USgal / 46ltr total capacity</li> <li>▪ 4 x Shower drain pumps with filters</li> <li>▪ 2 x Holding tanks - 42USgal / 160ltr total capacity (4 cabin)</li> <li>▪ 2 x Electric bilge pumps (keel sump) with float switches and alarm at switch panel</li> <li>▪ 2 x Manual bilge pumps with strum boxes (keel sump)</li> <li>▪ 2 x High water bilge float switches with alarm at switchpanel</li> <li>▪ 2 x Elec. bilge pumps (engine room) c/w alarm at switch panel</li> </ul> </li> </ul>	<ul style="list-style-type: none"> <li>▪ <b>Electric Sheet winch - Lewmar 55EST - 1 off</b></li> <li>▪ <b>Lazy Bag with Lazy Jack</b></li> <li>▪ Natural anodized mast</li> <li>▪ Natural anodized crossbeam c/w mooring cleats</li> <li>▪ Wind indicator</li> <li>▪ Mainsail full battened c/w 2 rows reefs</li> <li>▪ Additional spare conduit with messenger in mast</li> </ul>
<b>RUNNING RIGGING</b>	<b>GENERAL EQUIPMENT</b>
<ul style="list-style-type: none"> <li>▪ 2 x Main sheets (3:1 purchase)</li> <li>▪ 2 x Genoa sheets</li> <li>▪ 3 x Halyards (main, genoa &amp; spare)</li> <li>▪ 2 x Single line reefs lead aft</li> <li>▪ Main boom topping lift</li> <li>▪ Main outhaul led to helm station</li> </ul>	<ul style="list-style-type: none"> <li>▪ <b>Anchor and chain</b></li> <li>▪ <b>Anchor bridle, shackles and hook</b></li> <li>▪ <b>Fenders (x6), mooring lines (x4, 16mm x 10m), spring lines (x2, 16mm x 15m)</b></li> <li>▪ <b>Ocean liferaft and full safety equipment</b></li> <li>▪ <b>Dinghy</b></li> <li>▪ <b>Outboard engine 9,9 HP</b></li> <li>▪ 6 x Fire extinguishers</li> <li>▪ Owner's Operating Manual</li> <li>▪ CE Certification</li> <li>▪ NMMA Certification</li> </ul>



# Sailing catamaran Leopard 48

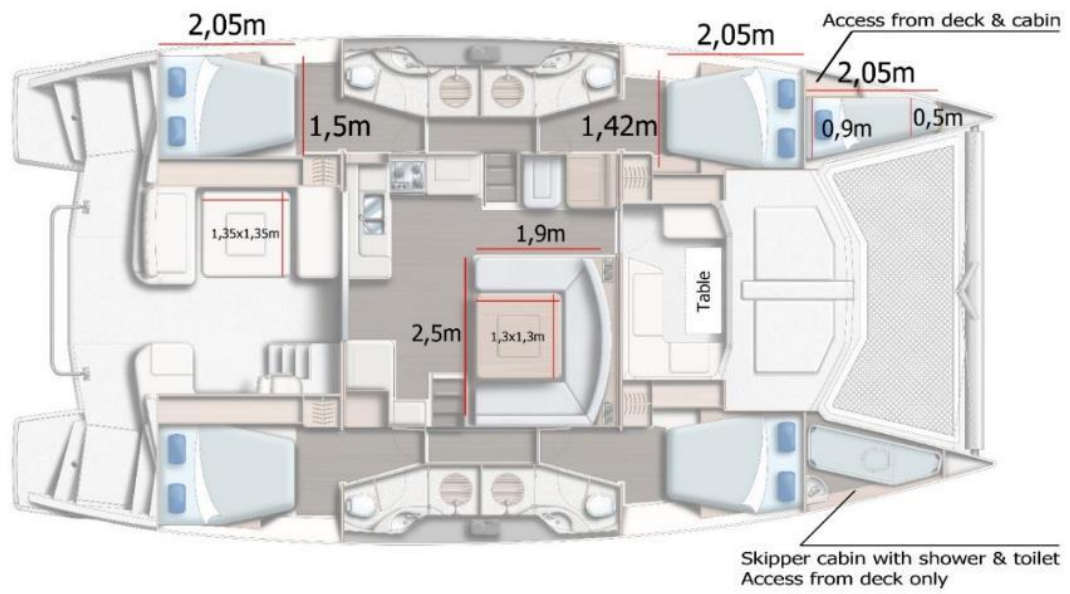

## Sailing catamaran Leopard 48



\* All pictures are for illustration only.